

ACS 186
Rubinetti portagomma
Hose-holder

PN25

MADE IN ITALY

- Valvole a sfera in ottone, nichelate solo sulla superficie esterna.
- Per impianti idrotermosanitari (adatte al consumo di acqua potabile secondo le recenti normative Europee).
- Installazione in impianti di riscaldamento industriale, civile, impianti pneumatici e per fluidi non aggressivi.
- Installazione in impianti di media pressione di distribuzione acqua.
- *Brass ball valves, nickel-plated only on the external surface.*
- *For hydro-thermo-sanitary systems (domestic water consumption according to recent European regulations).*
- *Installation in industrial and civil heating systems, pneumatic systems and for non-aggressive fluids.*
- *Installation in medium pressure water distribution systems.*

- Pressione di lavoro: 25 bar.
- Temperatura di pressione: -20°C +130°C (gelo escluso).
- Filetti: filetti cilindrici secondo norma ISO 228-1.
- Tenuta sull'asta: asta assemblata dall'interno con 2 OR in EPDM Perox.
- Tenuta sulla sfera con 2 sedi in PTFE.

- *Working pressure: 25 bar.*
- *Working temperature: -20°C +130°C (excluding frost).*
- *Threads cylindrical threads according to ISO 228-1.*
- *Seal on the stem: stem assembled from inside with 2 OR in EPDM Perox.*
- *Seal on the ball with 2 gaskets in PTFE.*

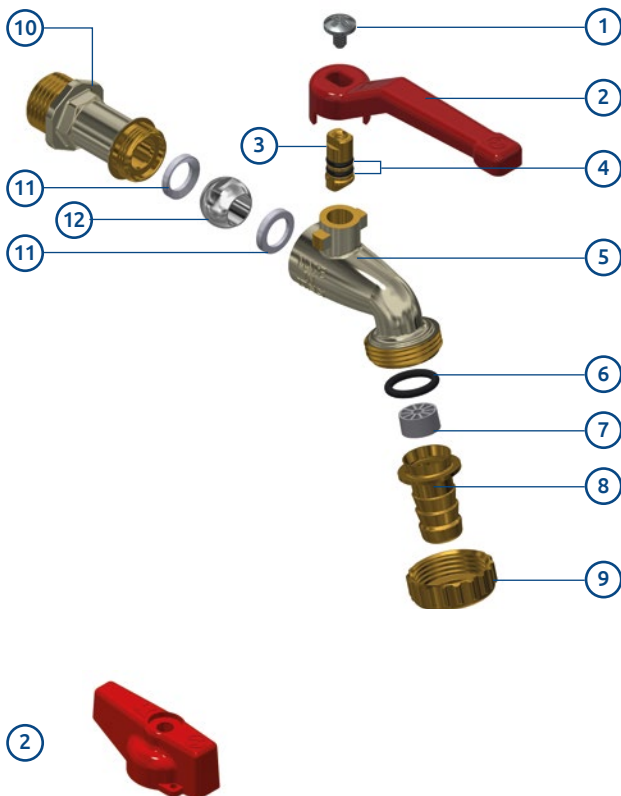



1. Vite in acciaio AISI 430.
2. Leva in acciaio o manopola in alluminio.
3. Asta in CW614N EN 12164.
4. O-ring in EPDM PEROX.
5. Corpo rubinetto cigno CW617N UNI EN 12165. nichelato solo sulla superficie esterna.
6. O-ring in EPDM PEROX.
7. Rompigetto in ABS.
8. Portagomma in CW617N UNI EN 12165.
9. Ghiera in CW617N UNI EN 12165.
10. Manicotto rubinetto curvo CW617N UNI EN 12165. nichelato solo sulla superficie esterna.
11. Sede PTFE.
12. Sfera in CW617N UNI EN 12165 cromato.

1. *Screw in steel AISI 430.*
2. *Drawn steel lever handle or aluminium knob.*
3. *Stem CW614N UNI EN 12164.*
4. *EPDM PEROX O-Ring.*
5. *Body valve CW617N UNI EN 12165 nickel-plated only on the external surface.*
6. *EPDM PEROX O-ring.*
7. *Hose end ABS.*
8. *Hose connection CW617N UNI EN 12165.*
9. *CW617N UNI EN 12165 nut.*
10. *CW617N UNI EN 12165 end adaptor, nickel-plated only on the external surface.*
11. *PTFE gasket.*
12. *CW617N UNI EN 12165 chrome-plated ball.*

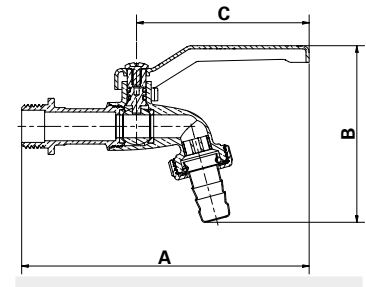

Con leva in acciaio imbutita
With drawn steel lever





Attacchi Connections	Codice prodotto Product code		PN	A ±1mm	B mm	C mm	Conf. num. pezzi Pack. num. pieces
							
1/2"	186D1/2G1R	186D1/2G1B	25	128,5	85	83	5/60
3/4"	186E3/4G1R	186E3/4G1B	25	144	104	83	3/36
1"	186F001G1R	186F001G1B	25	156,5	122	83	12

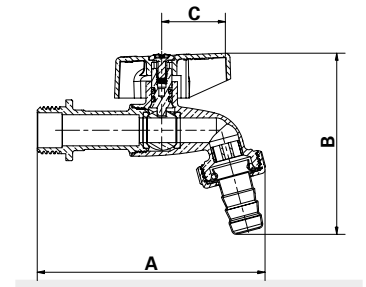

Con manopola in alluminio
With aluminium knob



Attacchi Connections	Codice prodotto Product code		PN	A ±1mm	B mm	C mm	Conf. num. pezzi Pack. num. pieces
							
1/2"	186D1/2G2R	186D1/2G2B	25	101	80,5	31,5	5/60
3/4"	186E3/4G2R	186E3/4G2B	25	122	99,5	31,5	3/36
1"	186F001G2R	186F001G2B	25	142	117,5	31,5	12