



353

Valvole a sfera ad angolo maschio/femmina

Elbow male/female ball valves

PN5



- Valvole a sfera in ottone tutte nichelate.
- Installazione in impianti di distribuzione del gas della 1ª - 2ª - 3ª famiglia.

- *Brass ball valves all nickel-plated.*
- *Suitable for 1st - 2nd - 3rd family gas distribution systems.*

- Pressione di esercizio: 5 bar.
- Temperatura di esercizio: -20°C + 60°C (gelo escluso).
- Filetti cilindrici secondo norma ISO 228-1.
- Tenuta sull'asta: asta assemblata dall'interno con 2 OR in VITON.
- Tenuta sulla sfera con 2 sedi in PTFE.

- *Working pressure: 5 bar.*
- *Working temperature: -20°C + 60°C (excluding frost).*
- *Cylindrical threads according to ISO 228-1.*
- *Seal on the stem: stem assembled from inside with 2 OR in VITON.*
- *Seal on the ball with 2 gaskets in PTFE.*

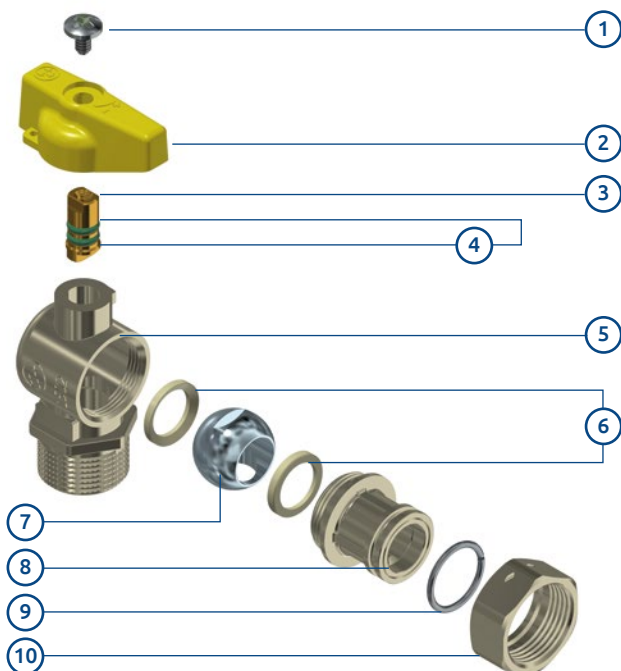

1. Vite in acciaio AISI 430.
2. Manopola in alluminio.
3. Asta in CW614N EN 12164.
4. O-ring in VITON.
5. Corpo valvola CW617N UNI EN 12165 nichelato.
6. Sede in PTFE.
7. Sfera in CW617N UNI EN 12165 cromata.
8. Manicotto in CW617N EN 12165 nichelato.
9. Anello elastico acciaio.
10. Dado CW617N UNI EN 12165 nichelato.

1. *Steel AISI 430 screw.*
2. *Aluminium knob.*
3. *CW614N UNI EN 12164 stem.*
4. *VITON O-ring.*
5. *CW617N UNI EN 12165 nickel-plated body valve.*
6. *PTFE gasket.*
7. *CW617N UNI EN 12165 chrome-plated ball.*
8. *CW617N UNI EN 12165 nickel-plated end adaptor.*
9. *Elastic ring steel.*
10. *Nut CW617N UNI EN 12165 nickel-plated.*



Con manopola in alluminio
With aluminium knob

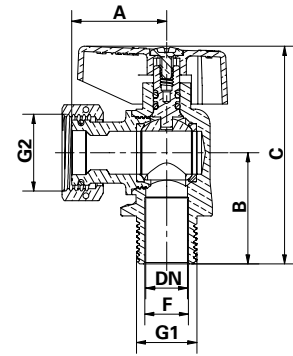

| Attacchi Connections | | Codice prodotto Product code | PN | DN | A ±0,5 mm | B ±0,2 mm | C mm | F mm | Conf. num. pezzi Pack. num. pieces |
|-------------------------|-----------|---------------------------------|----|----|--------------|--------------|---------|---------|---------------------------------------|
| G1 | G2 | | | | | | | | |
| 1/2" | 1/2" | 353D1/2C2G1/2 | 5 | 15 | 34,75 | 38,3 | 73 | 15 | 10/120 |
| 3/4" | 3/4" | 353E3/4C2G3/4 | 5 | 15 | 32,65 | 38,3 | 73 | 20 | 10/120 |